

I Get to know the router

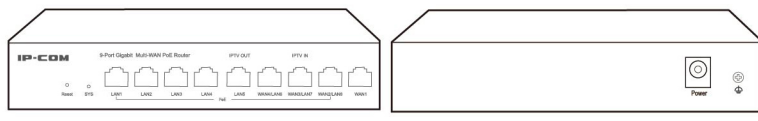

LED indicator status table with columns for LED indicator, Status, and Description.

Port/Button Description table listing LAN1-LAN4, LAN5 (IPTV OUT), WAN4/LAN6, WAN3/LAN7 (IPTV IN), WAN2/LAN8, WAN1, Reset, and Power ports.

II Install the router

- Router supports desktop mounting. Paste the four footpads to the four recesses on the bottom of the router. Then turn the router upside down, and place it horizontally on a big enough, clean, stable and flat desktop.

III Connect the router

- Use the power adapter included in the package to power the router. - The LAN or WAN/LAN port can supply PoE power to PoE-powered devices compliant with IEEE 802.3at or IEEE 802.3af.

Router mode

- The device is used as a router + wireless controller and is generally deployed at the egress gateway to act as a proxy for accessing the LAN.

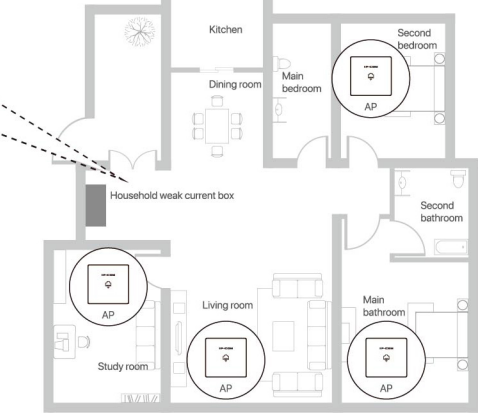
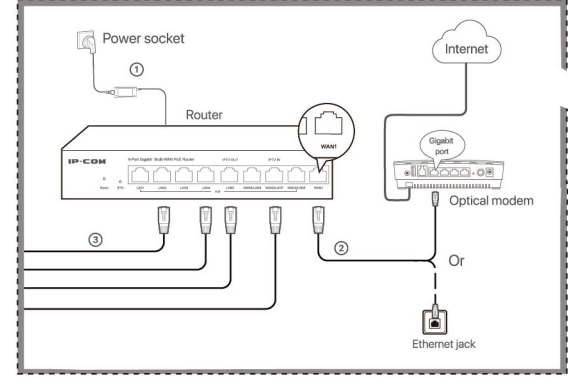

Pure AC mode

In pure AC mode, the device is used as a wireless controller and can be deployed under a switch. It can manage IP-COM APs without changing the original network structure.

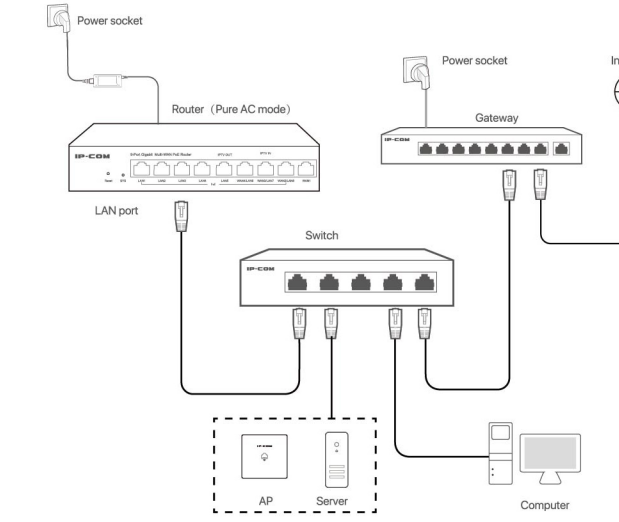

IV Configure the router

- 1. Connect terminal devices to the router. Method 1: Connect the wireless device such as a smartphone to the WIFI network of the AP connected to the router. Method 2: Connect the wired device such as a computer to the LAN port of the router using an Ethernet cable.

V Access the internet

Wired devices: Connect the wired device such as a computer to the LAN port of the router or the AP using an Ethernet cable to access the internet.

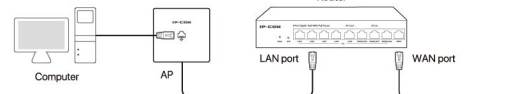

Wireless devices: The router has managed IP-COM APs. Connect the wireless device such as a smartphone to the WIFI network using the SSID you set. If you have not set it, the default WIFI name is IP-COM_XXXXXX (XXXXXX is the last six digits of the router's MAC address on the label of the router). And there is no password by default.

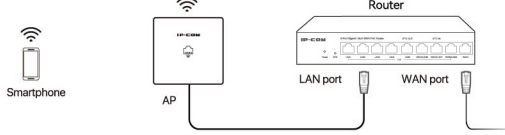

VI Manage the router through ProFi cloud

The router can be managed through the IP-COM ProFi cloud platform (https://imsen.ip-com.com.cn) locally on the LAN or remotely on the internet. Before managing the router through the IP-COM ProFi cloud platform, ensure that the network where the router is deployed is connected to the internet, and the router has been added to the IP-COM ProFi cloud platform.

FAQ

- Q1: I cannot log in to the web UI of the router by visiting ipcwifi.com or 192.168.0.252. What should I do? A1: Try the following solutions: - If you are using a wireless device, such as a smartphone, ensure that it connects to the WIFI of the AP connected to the router.

Q2: I cannot access the internet after the configuration. What should I do? A2: Try the following solutions:

- Check if the WAN port of the router is connected to a modem or Ethernet jack properly, and the corresponding port indicator is on.

Table mapping Internet parameters provided by ISP to Connection type you should choose (Static IP Address, Dynamic IP Address, PPPoE).

- If you still cannot access the internet, use an Ethernet cable to connect the computer to the LAN or WAN/LAN port of the router. Then log in to the web UI of the router, and confirm that AP management has been enabled. Navigate to AP > Wireless Policy > SSID Policy to modify the SSID or password and check the connection status.

Q3: How to reset the router? A3: When the SYS LED indicator blinks, hold the Reset button down with a needle-like object for about 8 seconds, and then release it when all the LED indicators light up. The router is restored to factory settings when the SYS LED indicator blinks again.

- Q4: Smartphones or other wireless devices cannot search the WIFI of the AP. What should I do? A4: Try the following solutions first: - Ensure that the WIFI function of wireless devices such as smartphones are normal and that other WIFI can be found.

QR code and multilingual contact information for English, Simplified Chinese, Vietnamese, Thai, Indonesian, Russian, Polish, French, Italian, and Spanish.

Technical specifications and manuals in Malayu, Italiano, Português, Polski, Français, and Lietuvių.

Technical specifications and manuals in Română, Magyar, Deutsch, Slovenský, and Русский.

Technical specifications and manuals in Čeština, Українська, Español, Hrvatski, and Slovenščina.

Technical specifications and manuals in Dansk, Nederlands, Suomi, and العربية.

CE Mark Warning and Declaration of Conformity in English, Italian, and Chinese.

Português and Polski declarations of conformity.

Română, Magyar, and Русский declarations of conformity.

Türkçe, Українська, and Español declarations of conformity.

Bългарски, Deutsch, and Čeština declarations of conformity.

Safety Precautions: Before performing an operation, read the operation instructions and precautions to be taken, and follow them to prevent accidents.

Português, Polski, and Français safety-related information.

Română, Magyar, and Русский safety-related information.

Türkçe, Українська, and Español safety-related information.

Bългарски, Deutsch, and Čeština safety-related information.

FCC Statement: This equipment has been tested and found to comply with the limits for a Class A digital device, pursuant to Part 15 of the FCC Rules.

RECYCLING: This product bears the selective sorting symbol for waste electrical and electronic equipment (WEEE).

Technical Support: Shenzhen IP-COM Networks Co., Ltd. Address: Room 101, Unit A, First Floor, Tower E3, No 1001, Zhongshan Yuan Road, Nanshan District, Shenzhen, China. 518052. Email: info@ip-com.com.cn. Website: www.ip-com.com.cn.