

DHI-LPH75-MC410-B

75" UHD Smart Interactive Whiteboard

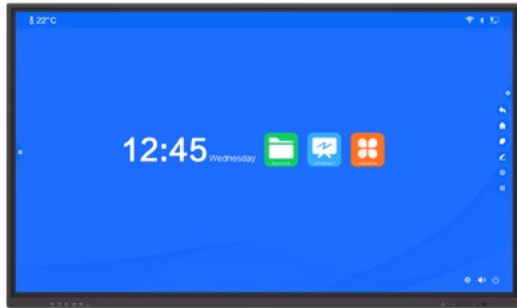

- 4K UHD display that delivers a clear image in sharp, vivid colors.
- Android and Windows can be easily switched between (PC module is required for Windows OS).
- Wireless screen sharing from multiple devices, such as phones, computers, and tablets.
- Built-in office document and media files support.
- The startup apps and signal source are all customizable.
- Wireless and wired network connection.
- Supports optional external Camera.

System Overview

Dahua DeepHub Lite Series Smart Interactive Whiteboard has powerful processing capabilities with its built-in 4-core CPU, 4-core GPU, 8G RAM, 32G storage, and Android 11 OS. With a high-precision infrared touch sensor and a 4K DLED display, Dahua DeepHub will give you an extraordinary experience of writing, controlling, and content displaying. It features video conferencing, wireless screen sharing, UHD display, scan & go, etc., and will be your go-to choice to digitalize your office and classrooms.

Scene

The whiteboard is ideal for use in indoor sites such as in meeting rooms and classrooms.

Functions

Real Writing Experience Whiteboard Solution

The intelligent whiteboard supports pen-point writing. With its Zero Air Gap technology and low latency, writing on the whiteboard feels natural, similar to the real writing experience.

Wireless Screen Sharing

In addition to basic file sharing, the device offers wireless screen sharing, interactive operations between two screens for multi-system include Android, IOS, Linux, Windows, MacOS, etc. It also supports screen grouping (multiple transmission), host mode (for overall permission control), real-time transmission of images, videos and audios from the wireless camera of the mobile phone to the device, and split-screen mode that displays up to 9 splits on the same screen.

Easy to Share

Enhances the experience of sharing files by scanning a code. It automatically determines the network of the device to readily share the QR code across the extranet and the intranet. QR code encryption and extraction are also featured, providing privacy and data security through the required entry of a 6-digit password for verification.

Technical Specification	
Built-in System	
Operating System	Android 11
CPU	Quad-core A55
RAM	8 GB
ROM	32 GB (optional 64G)
Function	
Operating System of External Module	Windows 7/8/10; Android
WiFi	Dual-band 2.4 G/5 G; 802.11 b/g/n/ac
Wi-Fi Hotspot	Dual-band 2.4 G/5 G; 802.11 a/b/g/n/ac ;supports enabling Hotspot and Wi-Fi at the same time
Bluetooth	5.0
Front Buttons	Screen Recording, Display Ratio, Volume, Settings, Eye Care, Power
MDM Support	Yes
OTA Support	Yes
Light Sensor	Yes
LCD Panel	
Panel Dimensions	75-inch
Backlight	DLED(Direct Light)
Aspect Ratio	16:9
Brightness	400 cd/m²
Resolution	3840 (H) × 2160 (V)
Response Time	<8ms
Viewing Angle	H: 178°; V: 178°
Lifespan	50,000 hours
Refresh Rate	60 Hz
Static Contrast	1200:1
Color Range	72% NTSC
Panel Type	IPS
Eye Protection Mode	Yes
Auto Brightness	Yes
Device Ports	
Front Ports	
USB 3.0	2× Type A
Type C	1
HDMI in	1 (HDMI2.0, Up to 3840×2160@30Hz)
USB Touch	2x Type B
Back Ports	

Network Port	1 x RJ45 in 1000M; 1 x RJ45 out
SPDIF	1 x COAX
Earphone	1 x mini jack in
MIC In	1 x mini jack in
AV In	1 x mini jack in
AV Out	1 x mini jack in
Ypbpr In	1 x mini jack in
VGA In	1 x DB15
VGA Audio In	1
HDMI in	2
DP in	1
RS232	1
Touch USB	1 x Type B
USB 3.0	3 x Type A
USB Type-C	1
TF Card	1

Touchscreen	
Touch Technology Type	Infrared touch technology
Response Time	<8 ms
Touch Points	20
Valid Touch	2 mm
Writing Mode	Finger + Pen
Touch Resolution	32767 × 32767
Operating System Support	Windows, Android, MacOS, Linux, ChromeOS

Speaker	
Power	15 W × 2
Built-in Speaker	2

General	
Power Supply	AC90V to AC264V
Power Consumption	<335 W (typical, without OPS)
Standby Power Consumption	0.5 W
Operating Temperature	0°C to +45 °C
Storage Temperature	−20 °C to +60 °C
Operating Humidity	10%–90%
Storage Humidity	10%–90%
Product Material	Metal casing
Glass	Anti-Smudge and Anti-dazzle tempered glass, hardness of 7H on the Mohs scale
Glass Thickness	4mm
Casing Color (Frame/Rear)	Black

Product Dimensions	1706×1102×121mm (with bracket)
Packaging Dimensions	1820×1240×200mm
Net Weight	58kg
Gross Weight	68kg
VESA	Support
Certifications	CE; ROHS; Erp; Energy Star
Packing List	1 x Smart interactive whiteboard 1 x Remote control 1 x Power cord (2m) 3 x Stylus pen 1 x instruction manual (including warranty card and certification info) 1 x Wall mount (including screws and installation instructions)

Installation

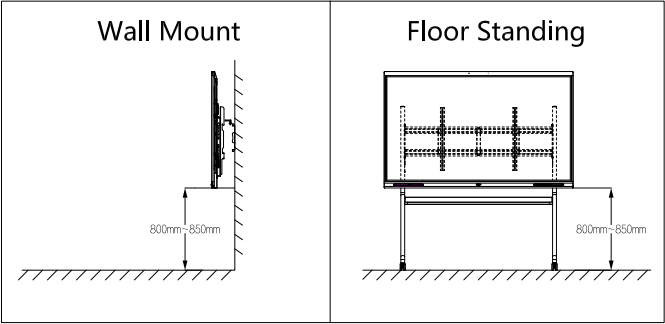

Dimensions (mm)

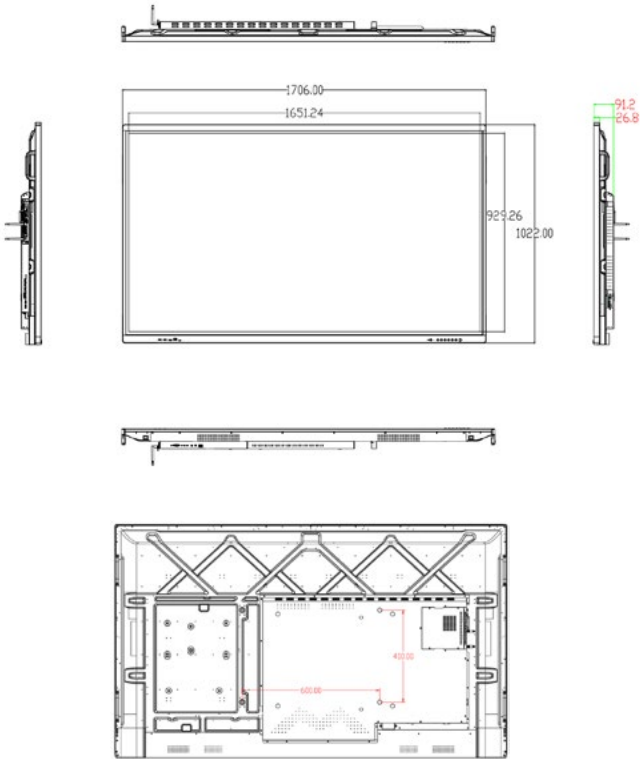

Ordering Information		
Type	Model	Description
75-inch Smart Interactive Whiteboard	DHI-LPH75-MC410-B	Smart Interactive Whiteboard DHI-LPH75-MC410-B
Accessories (Optional)	DHI-MP-PI7A77IL	PC module I7 Gen10 16 GB + 1TB (Wireless microphone, wireless keyboard & mouse included)